

MODULAR SIMPLI-FLEX[®]

ESF SERIES DISPENSER INSTRUCTIONS

MOUNTING THE DISPENSER:

Elevator dispensers may be mounted in any position.

1. Position wall brackets (#4) in desired location allowing sufficient height to dispense.
2. Mark location of screw holes on mounting surface.
3. Pre-drill holes for #10 x 3/4" mounting screws (#3) provided.

4. Screw wall brackets to mounting surface.

NOTE: screw anchors may be necessary when mounting on drywall or other thin substrate.

4. Position dispenser tube brackets (#2) over wall brackets. Slide dispenser into wall bracket until snug.

LOADING THE DISPENSER:

Your Modular SIMPLI-FLEX[®] dispenser model is completely self-adjusting and can dispense virtually any size or shape of cup! **Please clean dispenser before use - see below.**

1. Unwrap cups and gently push into dispenser tube, BOTTOM OF CUP FACING OUT.

CLEANING THE DISPENSER:

Your Modular SIMPLI-FLEX[®] dispenser is designed to provide an easy means of dispensing. The dispenser can be completely disassembled without tools to make regular cleaning simple and painless! Regular cleaning will prolong the life of the dispenser, keep it looking new and ensure sanitary dispensing.

TO CLEAN DISPENSER:

1. Remove dispenser from wall or mounting location.
2. Remove lid (#1), clamp ring (#5), gasket (#6), spring and pusher (#7).
3. Clean lid, clamp ring and gasket in hot, soapy water. Air dry. **Note: These parts are dish washer safe.**
4. Rinse inside of dispenser tube and wipe with a non-toxic cleaner/sanitizer.
5. Exterior of tube may be cleaned with any glass cleaner and a soft cloth.
6. Reassemble dispenser in reverse of above.

FIGURE 1.

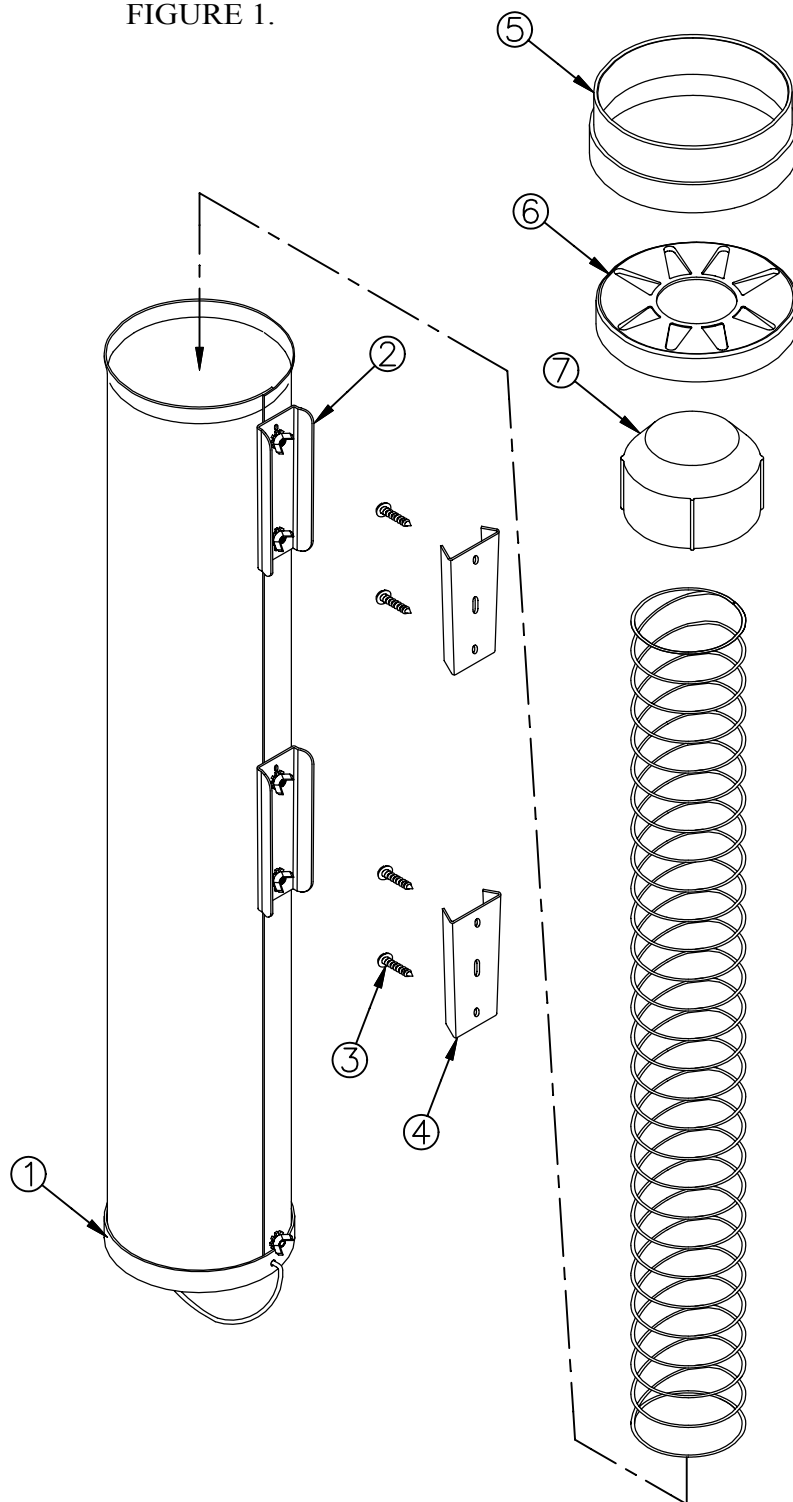

MODULAR[®]

DISPENSING SYSTEMS

DIVISION OF TOMLINSON INDUSTRIES

13700 Broadway Ave.
Cleveland Ohio 44125-1992

Phone: 216/587-3400

Fax: 216/587-0733

www.tomlinsonind.com

World Class, Worldwide

©Tomlinson Industries 2002

FORM 1907629 REV. 8/02
PRINTED IN U.S.A.

